

# CERTIFICATE OF LOCATION OF GOVERNMENT CORNER

NORTHEAST Corner of Section 8, Township 106, Range 43, 5TH P.M.

STATE OF MINNESOTA, County of MURRAY

At the corner location shown on the sketch:

On 07-20-2011 found a PK nail.  
DATE

left monument as found,  lowered monument,  removed monument (explain)

On \_\_\_\_\_ placed a \_\_\_\_\_  
DATE

### SKETCH OF REFERENCE TIES

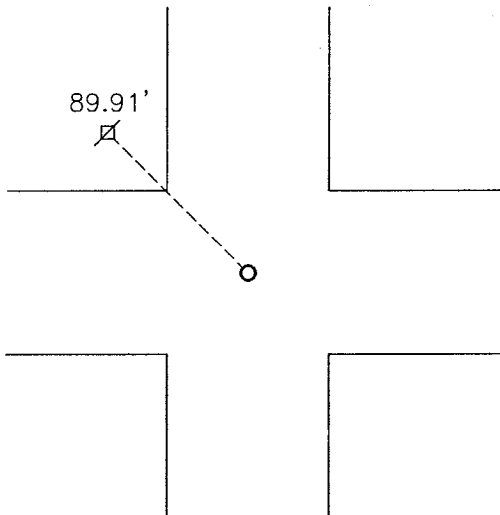

Minnesota State Plane Coordinate  
System Murray County Datum  
NAD83 (1996)

N: 158395.714  
E: 432239.129

Nail and survey marker in utility pole NW 89.91'

Statement of evidence relative to this corner location is on back of page.

I hereby certify that this document and the data contained herein was prepared by me or under my direct supervision.

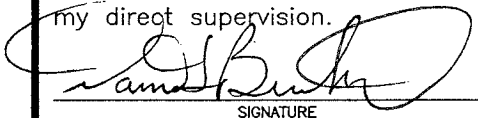
  
SIGNATURE

1/23/12  
DATE

Registration No. 43844

- Land Surveyor,  Professional Engineer  
 County Surveyor,  County Engineer

OFFICE OF THE COUNTY RECORDER  
County of \_\_\_\_\_

I hereby certify that this document was filed in the Co. Recorders office at \_\_\_\_\_ .M on the \_\_\_\_\_ day of JAN 25 2012 A.D. 20\_\_\_\_

County Recorder James V. Johnson  
By \_\_\_\_\_, Deputy

DOCUMENT NO. \_\_\_\_\_

## Statement of Evidence

In 1866, J. W. Bishop did the original subdivision of the township.

On September 13, 1927, a stone was located at the corner.

On July 18, 1983, the Murray County Highway Department found a concrete monument over a field stone. They set a railroad spike at the surface.

On December 12, 1998, Zieske Land Surveying, Inc., found a PK nail at the surface and in the center of the road.

On July 20, 2011, Bueltel-Moseng Land Surveying found a PK nail at the road surface.